

ARCHITECTURAL GENERAL NOTES

- 1 NOTES APPLY TO ALL SHEETS
- 2 ALL INTERIOR DIMENSIONS ARE FROM FACE OF STUD, COLUMN LINES, MASONRY
- 3 ALL CONTRACTORS SHALL VERIFY ALL DIMENSIONS AND JOB SITE CONDITIONS. ANY DISCREPANCY SHALL BE BROUGHT TO THE ATTENTION OF THE ARCHITECT BEFORE PROCEEDING WITH THE WORK.
- 4 THE PLUMBING AND MECHANICAL CONTRACTORS SHALL NOTIFY THE GENERAL CONTRACTOR OF ANY EQUIPMENT LOCATIONS THAT MAY REQUIRE THICKENING OF WALLS OTHER THAN THOSE SHOWN ON PLANS.
- 5 ALL TRADES SHALL COORDINATE WITH THE GENERAL CONTRACTOR THE SIZES AND LOCATIONS OF ALL ACCESS DOORS REQUIRED FOR THEIR WORK. THE RESPECTIVE TRADE SHALL SUPPLY THE DOORS TO THE GENERAL CONTRACTOR FOR INSTALLATION.
- 6 ALL INTERIOR STUD PARTITIONS ARE 3 5/8" METAL STUDS AT 16" o.c. UNLESS NOTED OTHERWISE.
- 7 THE GENERAL CONTRACTOR SHALL FURNISH AND INSTALL ALL WOOD BLOCKING IN WALLS WHERE SURFACE MOUNTED DEVICES ARE LOCATED. FIELD VERIFY MOUNTING HEIGHTS AND LOCATIONS FOR ALL DEVICES. ADA DEVICES SHALL COMPLY WITH ADA ACCESSIBILITY REQUIREMENTS.
- 8 ALL FIRE EXTINGUISHERS WITH BRACKETS (FE-2) TO BE MOUNTED WITH TOP OF FIRE EXTINGUISHER AT 48 INCHES A.F.F., REFERENCE PLANS FOR LOCATIONS.

**FLOOR PLAN - DESIGN OPTION 1**

1/4" = 1'-0"

**NOT FOR CONSTRUCTION**

PROJECT NAME:  
**Crossroads Lexington**  
 907 W 8TH STREET  
 FLOOR PLAN - DESIGN OPTION 1

BRAWN BY:  
**A. ENGLISH**  
 DATE:  
 08/11/2022  
 PROJECT NO:  
 22043  
 SCALE:  
 1/4" = 1'-0"  
 SHEET NO:

DESIGN/BUILD - GENERAL CONTRACTORS  
 GRAND ISLAND, NE (308) 389-7222  
 KEARNEY, NE (308) 238-2755  
<http://www.chiefconstruction.us>

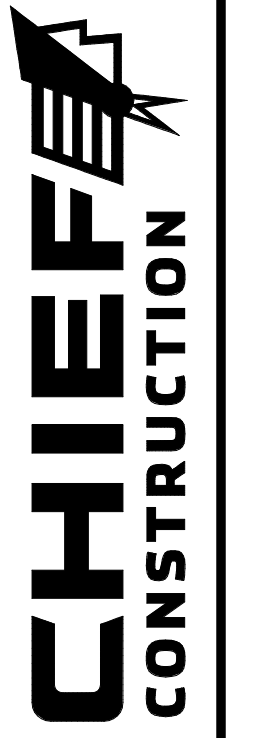

**CONFIDENTIAL**

These plans are the property of CHIEF CONSTRUCTION. They are not to be reproduced or distributed in any manner without the written consent of CHIEF CONSTRUCTION.

**A-1.0**

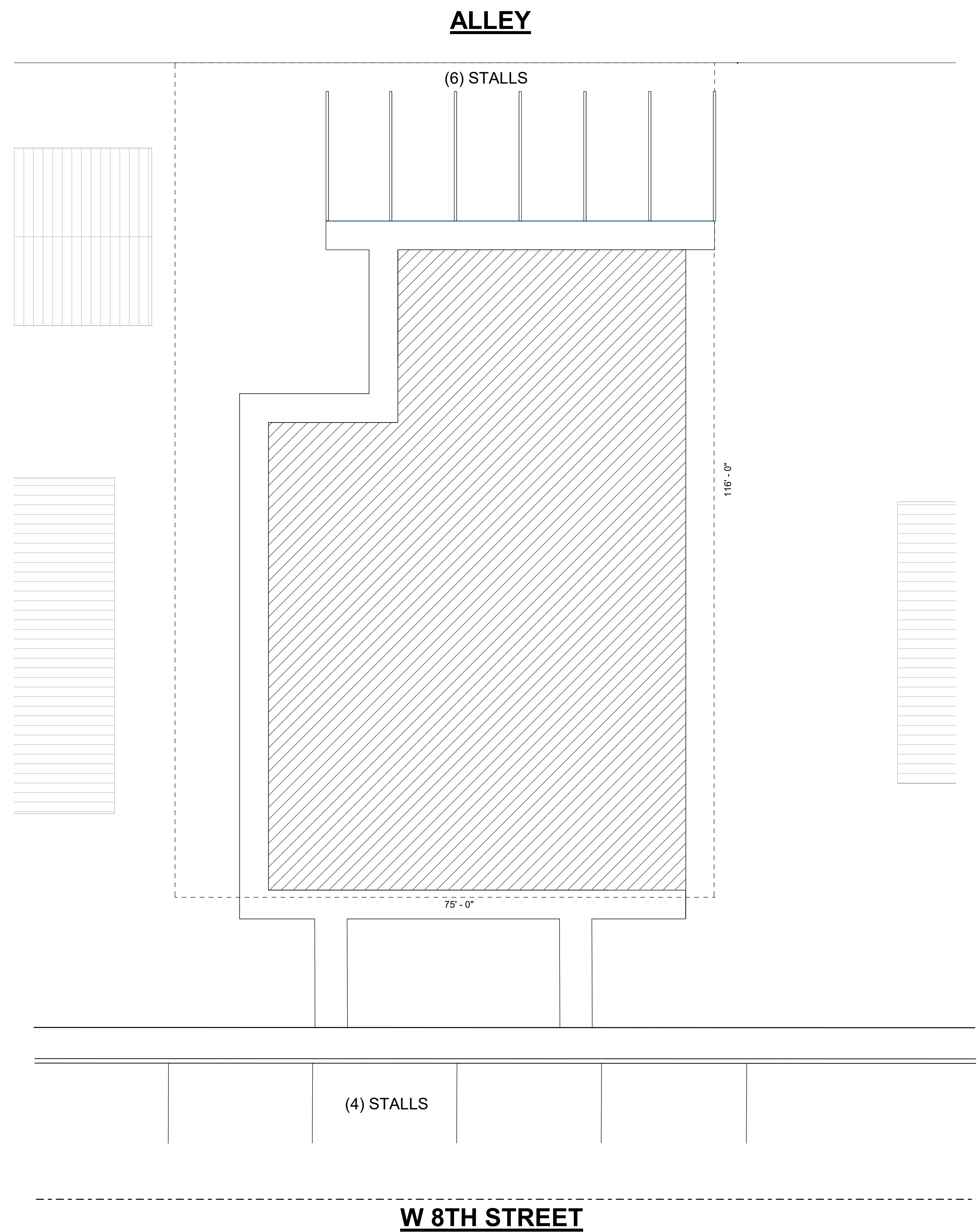

1 SITE PLAN  
1" = 10'-0"

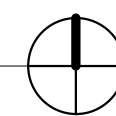

**NOT FOR CONSTRUCTION**

**CONFIDENTIAL**  
These plans are the property of  
CHIEF CONSTRUCTION.  
They are not to be reproduced  
or distributed in any manner  
without the written consent of  
CHIEF CONSTRUCTION.

DESIGN/BUILD — GENERAL CONTRACTORS  
GRAND ISLAND, NE (308) 389-7222  
KEARNEY, NE (308) 238-2755  
http://www.chiefconstruction.us



PROJECT NAME:  
**Crossroads Lexington**  
907 W 8TH STREET  
SITE PLAN

BRAWN BY:  
**A. ENGLISH**  
DATE:  
**08/10/22**  
PROJECT NO:  
**22043**  
SCALE:  
**1" = 10'-0"**  
SHEET NO:

**A-1.4**